

Sold

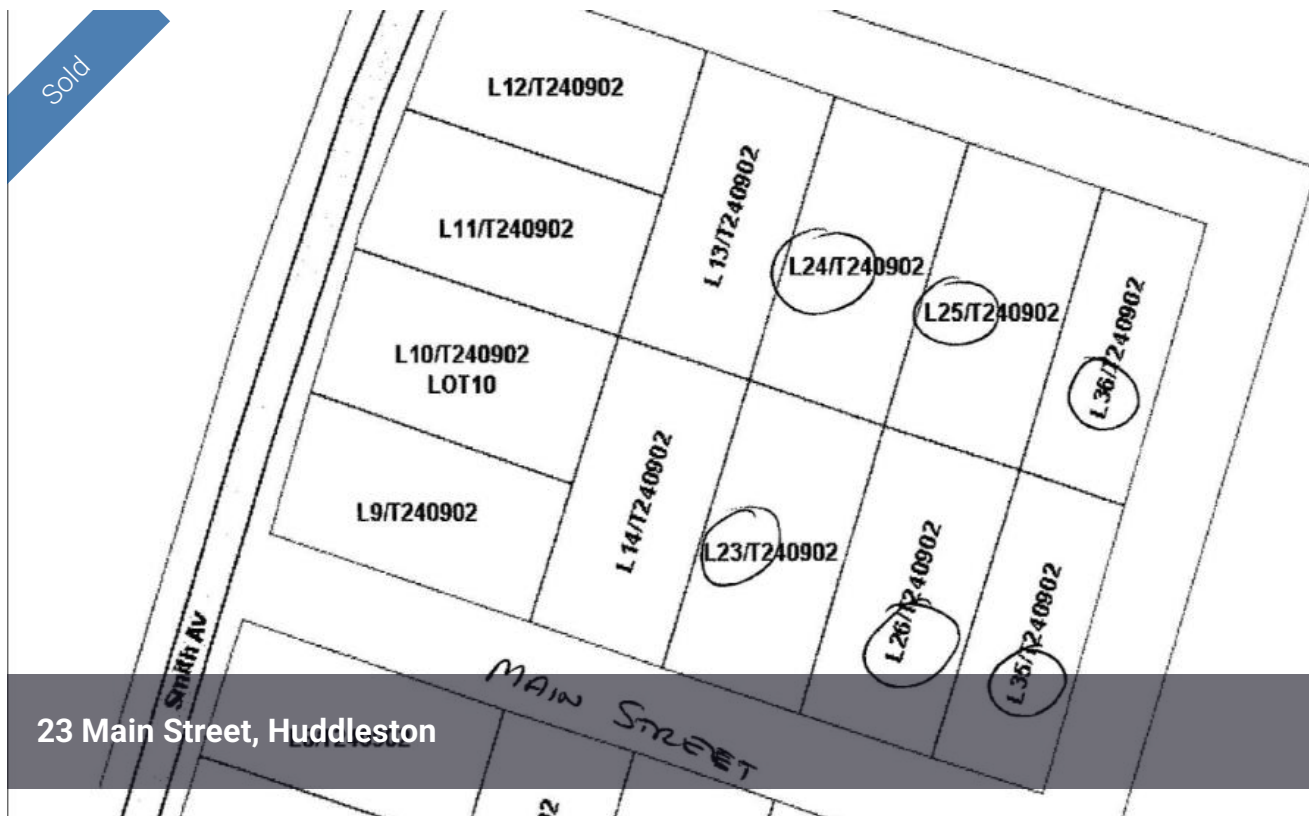

23 Main Street, Huddleston

## The Price is Correct

These parcels of land are located in the sleepy township of Huddleston which is located east of Crystal Brook. Selling as a whole these six allotments 23,24,25,26,35 & 36 each have there own titles and each having and area of 2072M2. The land is currently being cropped with no fixed lease. access to the land is via road ways which is shown on the attached map. No water or power connected. Please quote allotment 23 in Volume 5494 Folio 3 to ETSA and SA Water for quotes. Please note that the land has not got survey pegs. Zoned General farming.

The above information provided has been furnished to us by the vendor/s. We have not verified whether or not that information is accurate and do not have any belief in one way or the other in its accuracy. We do not accept any responsibility to any person for its accuracy and do no more than pass it on. All interested parties should make and rely upon their own inquiries in order to determine whether or not this information is in fact accurate.

12 m2

<b>Price</b>	SOLD
<b>Property Type</b>	Residential
<b>Property ID</b>	1121
<b>Land Area</b>	12 m2

### Agent Details

Martin Stringer - 0417 897 159

### Office Details

Port Pirie  
90 Florence Street Port Pirie, SA,  
5540 Australia  
08 8633 4555

**WARDLE**  
Co.  
Real Estate